

PITMEC

THE PCON-E 745 CONCENTRIC UNDERREAMING SYSTEM



CASING SIZE 813MM OD X 781MM ID DRILLING DIA. 835MM

PNEUMEC PCON-E 745 CONCENTRIC UNDERREAMING SYSTEM

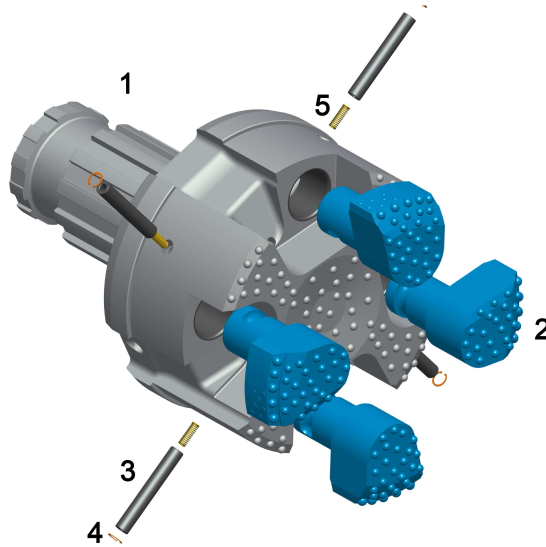

PCON-E 745 PARTS LIST

1.	DRIVER BIT N240 SHANK	UGD745N24PCE
2.	REAMER (4)	UBS745PCE
3.	LOCKING PIN (4)	USP74550PCE
4.	CIRCLIP (4)	USP74553PCE
5.	SPRING (4)	USP74554PCE
6.	COMPLETE SYSTEM	UCS745N18PCE

PCON-E 745 SPECIFICATIONS

UPPER BODY DIAMETER	776MM	CLOSED DIAMETER	745MM
REAMING DIAMETER	835MM	CASING SIZE	813MM OD X 781MM ID
SYSTEM LENGTH	925MM	SYSTEM WEIGHT	1530KG

PCON-E 745 CASING SHOES

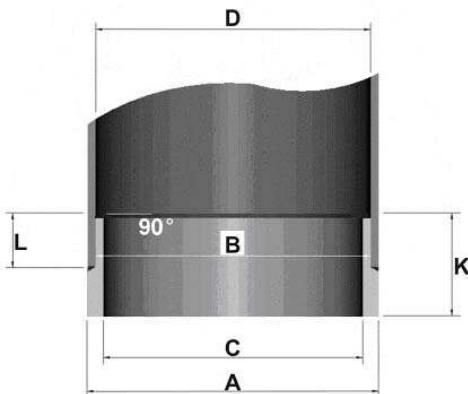

DIA. A	813MM
DIA. B	778.5MM
DIA. C	747MM
DIA. D	780MM
L	80MM
K	145MM

PNEUMEC

PNEUMEC COMPANY LIMITED

1st Floor, Tin On Sing Comm. Bldg., 41-43 Graham St. Central, H.K.

Tel : (852) 2180 9922

Fax : (852) 2180 9982

Website : www.pneumec.com

email : info@pneumec.com